

3B & 3C Burfield Park, Hailsham, BN27 3JL

£500 PCM

Commercial unit To Let in popular Hailsham Business Park Burfield Park. Available immediately. The unit has separate office space and adjoining storage.

3B & 3C Burfield Park, Hailsham, BN27 3JL

£500 PCM



- Commercial Unit
- Business Park
- 2-3 Offices
- Adjoining Storage
- Recently Refurbished
- Available Now



Directions



Ground Floor

Approx. 46.2 sq. metres (497.3 sq. feet)

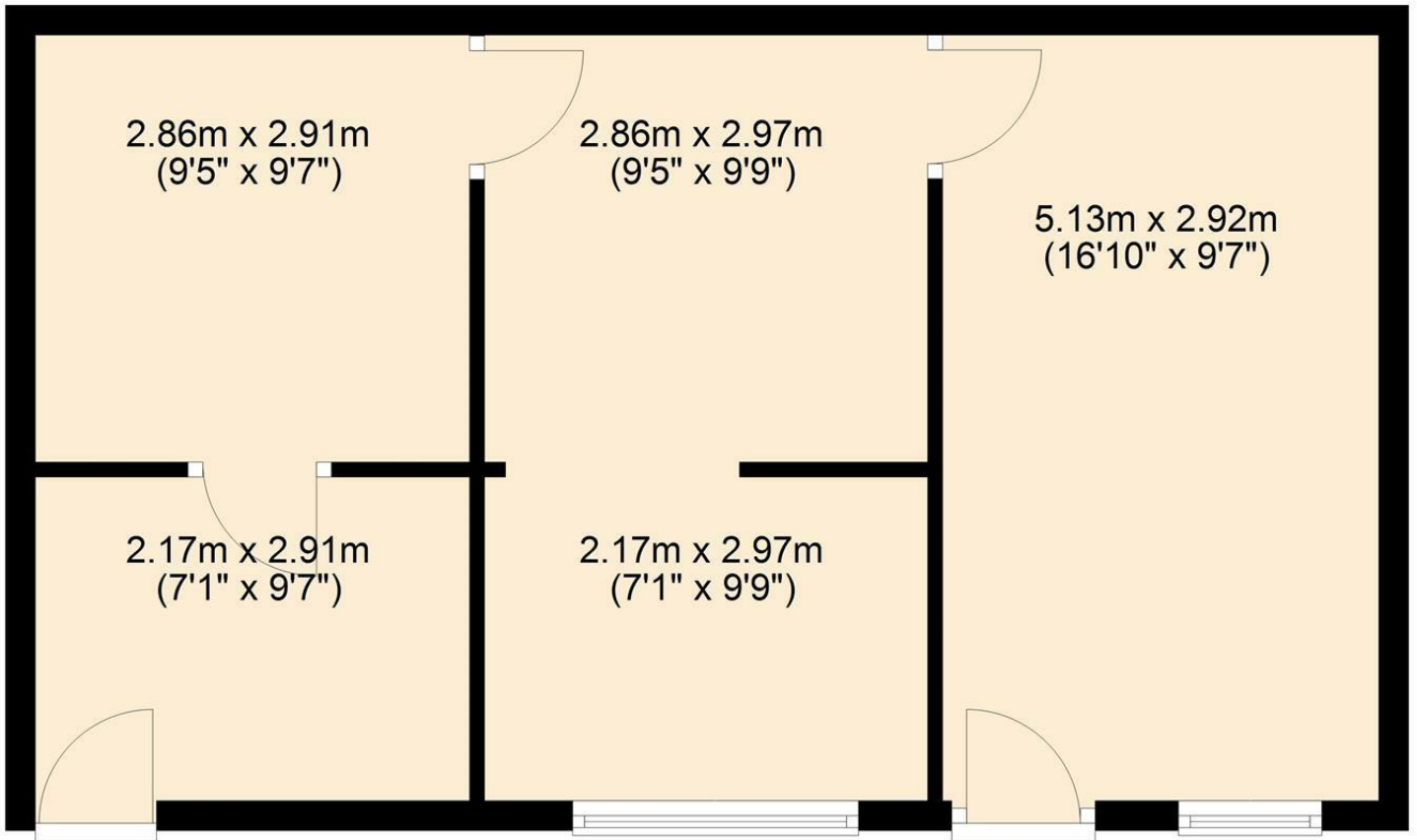

Total area: approx. 46.2 sq. metres (497.3 sq. feet)

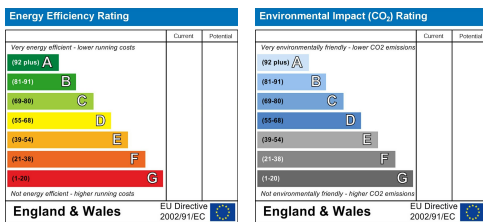

These particulars, whilst believed to be accurate are set out as a general outline only for guidance and do not constitute any part of an offer or contract. Intending purchasers should not rely on them as statements of representation of fact, but must satisfy themselves by inspection or otherwise as to their accuracy. No person in this firm's employment has the authority to make or give any representation or warranty in respect of the property.

57 St Leonards Road, Bexhill-On-Sea, TN40 1JA

Tel: 01424 730678 | Email: info@maltbys.uk

www.maltbys.uk